



roto-jet® **Overhead Rail
Shot Blast Machines**

SCHLICK *roto-jet*[®] Overhead Rail Shot Blast Machines



- 1 Workpiece bundle
- 2 Y-switch
- 3 Noise dampening housing
- 4 *roto-jet*[®] turbine
- 5 Drag and rotation unit
- 6 Screw worm conveyor
- 7 Wind sifter
- 8 Bucket elevator
- 9 Switch box
- 10 Secondary filter
- 11 Dust bag
- 12 Cartridge filter

Alternatively:
Wet filter for aluminium workpieces.



Overhead rail shot blast machines are available in continuous and discontinuous passage execution as well as in various sizes and executions. Please contact us!

SCHLICK *roto-jet*[®] overhead rail type shot blast machines offer total flexibility in your shot blast operations. Whether you are cleaning welded structures and fabrications, cleaning and deburring castings, or shot peening dynamically stressed components, the range of applications is nearly inexhaustible.

With well known SCHLICK reliability, longevity and progressive engineering and the advantage of the *roto-jet*[®] blast wheel, SCHLICK overhead rail shot blast machines present unequalled productivity and effectiveness. There is a further step to higher productivity with the option of the SCHLICK η [eta] blast wheel system in place of the standard wheel. With advanced technology, the η [eta] wheel considerably increases blasting performance and resistance to wear.

SCHLICK *roto-jet*[®] overhead rail shot blast machines – because we want to be your partner tomorrow!

It's a *roto-jet*[®]!

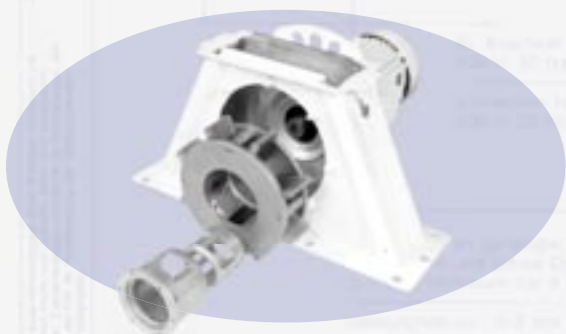

Due to the combined rotation and oscillating action in the blast chamber, difficult to access workpieces, can be confidentially cleaned.

Extract from our standard program

Subject to technical alterations.

<i>roto-jet</i> [®] type of machine	HB 10/12	HB 12/16	HB 12/20	HB 16/16	HB 16/22	HB 16/26
Max. diameter of workpiece bundle [mm]	1000	1200	1200	1600	1600	1600
Max. height of workpiece [mm]	1200	1600	2000	1600	2200	2600
Max. weight of workpiece [kg]	800	800	800	800	800	800
Number of turbines x capacity [kW]	2 x 7,5	2 x 7,5	3 x 7,5	2 x 7,5	3 x 7,5	3 x 7,5
Optional	2 x 11	2 x 11	3 x 11	2 x 11	3 x 11	3 x 11
Base of machine [mm](incl. Y-overhead rail system, without filter)	4080 x 3500	4680 x 4200	4680 x 4200	5380 x 5650	5450 x 5650	4650 x 5650
Foundation pit or electro chain hoist recommended	no	yes	yes	yes	yes	yes
Installation <i>without</i> foundation pit						
Height of the machine [mm]	4140	4845	5690	5025	6100	6510
Lower edge / upper edge of workpiece [mm]	760 / 1960	880 / 2480	955 / 2955	1100 / 2700	1175 / 3375	1175 / 3775
Installation <i>with</i> foundation pit						
Depth of foundation pit [mm]	500	700	780	925	1000	1000
Height of machine [mm]	3640	4145	4910	4100	5100	5510
Lower edge / upper edge of workpiece [mm]	260 / 1460	180 / 1780	175/2175	175 / 1775	175 / 2375	175 / 2775

You cannot find *your* machine? We would be pleased to offer you further individual modifications and options especially for your applications. What can we do for *you*?

**DELIVERING.
THE RIGHT SOLUTION**



Your local Contact:



Schlick

Heinrich-Schlick-Straße 2

48629 Metelen

Germany

Phone: +49 (0) 25 56 - 88 - 0

Fax: +49 (0) 25 56 - 88 - 1 50

eMail: schlick@surfacepreparation.de

Internet: www.schlick.de



**INTERNATIONAL
SURFACE PREPARATION**

www.surfacepreparation.com